

N A I S H

ESTATE AGENTS



YORK  
EST. 1939



## Flat 12 Toft Green Court Toft Green

, York, YO1 6JJ

Great location in the centre of the Historic city of York. Modern one bedroom Apartment with Open Plan Kitchen/Diner Living Room, Shower room, Third Floor, Electric Heating. Bike Store available. NO Parking. Available from End of June

**£975 Per Month**

# Flat 12 Toft Green Court Toft Green

, York, YO1 6JJ



- Great Central Location
- Open plan kitchen living room
- Communal Bike Storage
- Modern Apartment
- Top Floor of four floors
- Available late June early July
- One bedroom
- Shower room

## Property Description

## Costs and Utilities

## Environs

## Holding Deposit

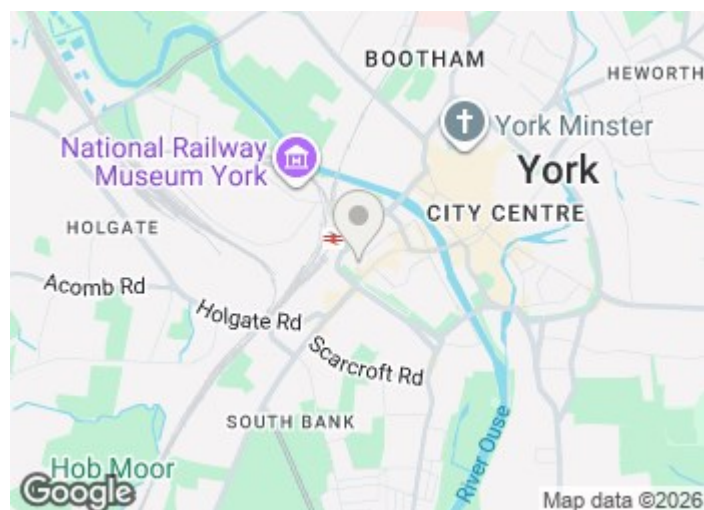

## Directions



# Floor Plan

2ND FLOOR  
346 sq.ft. (32.2 sq.m.) approx.

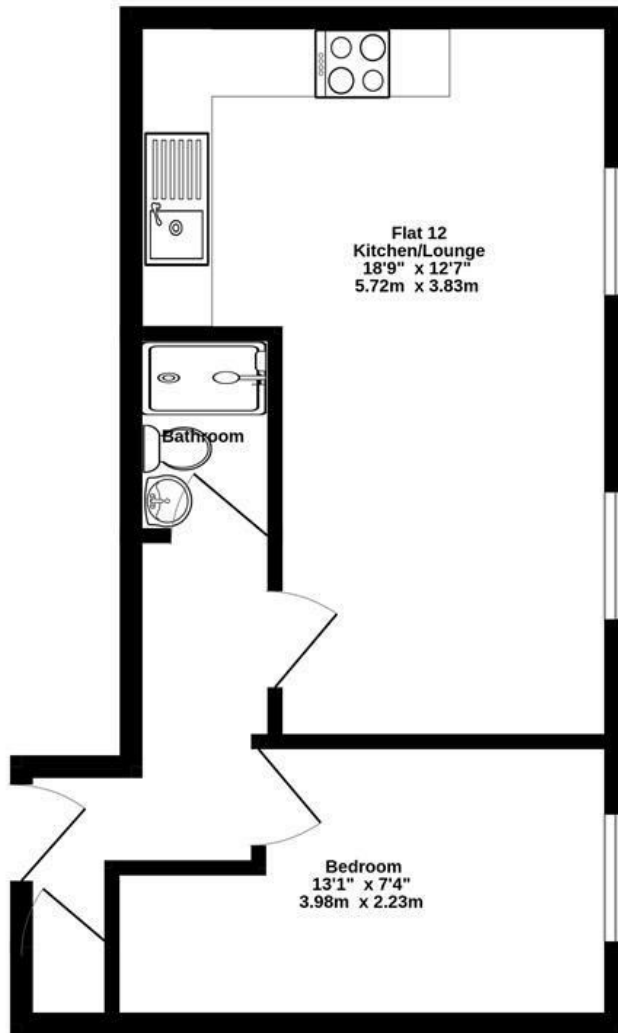

TOTAL FLOOR AREA : 346 sq.ft. (32.2 sq.m.) approx.

Whilst every attempt has been made to ensure the accuracy of the floorplan contained here, measurements of doors, windows, rooms and any other items are approximate and no responsibility is taken for any error, omission or mis-statement. This plan is for illustrative purposes only and should be used as such by any prospective purchaser. The services, systems and appliances shown have not been tested and no guarantee as to their operability or efficiency can be given.  
Made with Metropix ©2026

These particulars, whilst believed to be accurate are set out as a general outline only for guidance and do not constitute any part of an offer or contract. Intending purchasers should not rely on them as statements of representation of fact, but must satisfy themselves by inspection or otherwise as to their accuracy. No person in this firm's employment has the authority to make or give any representation or warranty in respect of the property.

3 High Petergate, York, YO1 7EN  
Tel: 01904 653564 Email: naish@naishproperty.co.uk www.naishproperty.co.uk

| Energy Efficiency Rating                    |  | Current                 | Potential |
|---|--|-------------------------|-----------|
| Very energy efficient - lower running costs |  |                         |           |
| (92 plus) <b>A</b>                          |  |                         |           |
| (81-91) <b>B</b>                            |  |                         |           |
| (69-80) <b>C</b>                            |  | 79                      | 85        |
| (55-68) <b>D</b>                            |  |                         |           |
| (39-54) <b>E</b>                            |  |                         |           |
| (21-38) <b>F</b>                            |  |                         |           |
| (1-20) <b>G</b>                             |  |                         |           |
| Not energy efficient - higher running costs |  |                         |           |
| <b>England &amp; Wales</b>                  |  | EU Directive 2002/91/EC |           |